



Oil and Fuel Filter Vessels

Model VKS-6, VKS-10, and VKS-16

The Model VKS oil and fuel filtration filter vessels are designed to offer a high quality solution for industrial oil and fuel filtration applications. The VKS Vessels are rugged, heavy-duty, carbon steel constructed, and designed and built per ASME Code. The Model VKS vessels are designed to provide oil filtration or fuel filtration for a wide range of industrial applications. The Model Model VKS vessels can be used in the following industrial applications:

- Power Plants – turbine oil, gear oil, and diesel fuel
- Pulp & Paper Mills – paper machine oil and hydraulic oil
- Steel and Aluminum Mills – rolling mill lube system oil, gear oil, hydraulic oil, and cutting oil
- Marine – engine oil and diesel fuel
- Mining – crusher lube system oil and diesel fuel
- Refinery and Chemical Plants – compressor and turbine oil
- Fueling Terminals – diesel fuel
- General Industry – lube oil, hydraulic oil, transformer oil, and diesel fuel



BENEFITS

- o ASME Code Construction: Using the trustworthy ASME Code design criteria, the Model VKS vessels are built for reliable and long term use in any industrial environment.
- o Equipment Protection: The Model VKS vessel can be used in oil or diesel fuel applications
- o Oil - Protects components in your oil system
- o Diesel Fuel - Guards against contamination entering your diesel engine.
- o Simple, Secure Element Alignment and

Sealing Design: The VKS vessel element standpipe design prevents fluid by-pass by providing proper element alignment and furnishes tight and secure element sealing with the single piece element hold-down tool. In addition, the single piece element hold-down tool also allows for simple and quick element replacement.

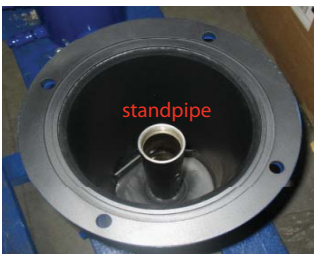

SPECIFICATIONS & DETAILS

Pressure and Temp.	150 PSIG (10.3 BAR) at 250 F (121 C) ASME Code Section VIII, Div. 1, "U" Stamp
Environmental Parameters	Minimum Temperature: 0 F (-17 C) Maximum Temperature: 120 F (49 C)
Materials of Construction	Metals: Carbon Steel / Bronze Elastomers: Viton Exterior Coating: Acrylic Urethane Enamel Interior Coating: Rust Preventative
Inlet/Outlet Connections	VKS-6: 3 inch / VKS-10: 4 inch / VKS-16: 6 inch Type: 150 pound Raised Face (RF) Flange
Fluid Compatibility	Mineral Base Oils and Fuels (diesel # 1 and #2)
Weight	VKS-6: 450 lbs (205 kgs) / VKS-10: 825 lbs (375 kgs) VKS-16: 1,125 lbs. (510 kgs)
Dimensions	VKS-6: 28 inches L x 24 inches W x 55 inches H (715 mm L x 610 mm W x 1400 mm H) VKS-10: 32 inches L x 28 inches W x 61 inches H (815 mm L x 715 mm W x 1550 mm H) VKS-16: 36 inches L x 32 inches W x 66 inches H (915 mm L x 815 mm W x 1680 mm H)
Element Selection	General Purpose Oil or Fuel Filtration: KF6036-05 / KF6036-5 / KF6036-10 Critical Purpose Oil or Fuel Filtration: KM6036-02 / KM6036-05 / KM6036-2 / KM6036-3 / KM6036-8 / KM6036-15 Water Absorption from Oils or Fuel: KQD6036-6NS
Element Quantity	KF, KQD, or KM Elements VKS-6: 3 required, VKS-10: 5 required, VKS-16: 8 required
Performance ⁽¹⁾	ISO Cleanliness Codes: ISO Cleanliness Codes: KF6036-05 - ISO 15/13/11 KM6036-02 - ISO 15/13/10 KF6036-5 - ISO 18/16/13 KM6036-05 ISO 15/13/11 KF6036-10 - ISO 19/17/14 KM6036-2 - ISO 16/14/12 KQD6036-5 - ISO 18/16/13 KM6036-3 - ISO 16/15/13 <i>Water Removal to less than 200 ppm</i> KM6036-8 - ISO 18/17/14 KM6036-15 - ISO 19/18/15
Vessel Lid Seals ⁽²⁾	VKS-6: Part Number 300974 VKS-10: Part Number 300975 VKS-16: Part Number 300976

OPTIONS

Descriptions			
By-Pass Valve (15, 25, or 40 psid)	Differential Pressure Device <i>DP Gauge (switch optional)</i>	Automatic Air Release	Pressure Relief Valve

FOOTNOTES: (1) As measured with inline automatic particle monitor calibrated to ISO 11171 and influent no greater than ISO 20/19/16 (2) Required for element changes.

EXTERNAL BYPASS	
SYMBOL	DESCRIPTION
N	MANUAL AIR RELEASE ONLY
A	AUTOMATIC AIR RELEASE VALVE
R	PRESSURE RELIEF VALVE
AR	PRESSURE RELIEF VALVE AND PRESSURE RELIEF VALVE

N

N

MODEL

VKS

MODEL SIZE	
SYMBOL	NO. OF ELEMENTS
6	18"
6	36"
10	18"
10	36"
16	18"
16	36"

INTERNAL BYPASS	
SYMBOL	DESCRIPTION
N	NO BYPASS STANDARD
S	25 P.S.I.D. BYPASS
40	40 P.S.I.D. BYPASS

DIMENSION	VKS6	VKS10	VKS16
A	16.00	20.00	24.00
B	46.19	49.12	51.94
C	9.56	12.75	16.44
D (56" ELE.)	82.19	85.12	87.94
E	4.44	6.00	7.69
F	7.31	10.00	12.56
G	2.00	2.19	2.50
H	12.63	14.88	16.88
J	28.00	32.00	36.00
K	14.00	16.00	18.00
L	3.00	4.00	6.00
M	20.88	24.88	28.88
N	12.56	15.50	18.25
P	12.56	15.50	18.25
DRY WEIGHT (LBS)	450	825	1125
VOLUME, APPROX. (GAL)	37	63	95

- NOTES:
- DESIGN PRESSURE: 150 P.S.I. AT 250T.
 - HYDROSTATIC TEST PRESSURE: 225 P.S.I.
 - EXTERIOR FINISH: -- KAYDON BLUE.
 - UNIT SHIPPED WITH ALL OPEN CONNECTIONS PROTECTED WITH PLASTIC PROTECTORS.
 - DESIGNED, CONSTRUCTED, AND LABELED IN ACCORDANCE WITH PARAGRAPH UW-12(C) OF THE LATEST A.S.M.E. CODE SECTION VIII.
 - UNIT SHIPPED WITHOUT ELEMENTS.
 - ALL KAYDON 6036 ELEMENTS FIT THIS HOUSING.

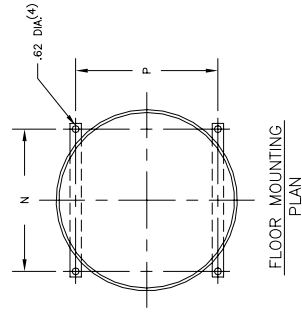
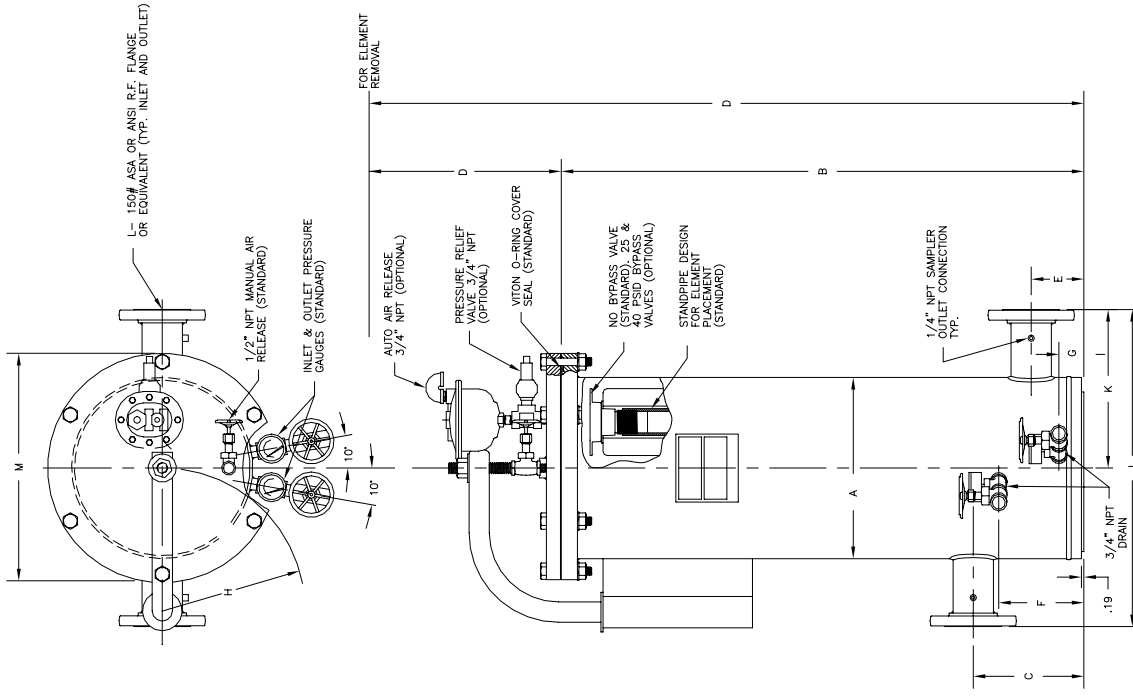

REV.	ECN.	DESCRIPTION	BY	DATE
1	105	TOLERANCE UNLESS SPECIFIED DIMENSIONS ARE IN INCHES		
KAYDON CORPORATION				
DESIGNER	DATE	TEST	DATE	
APPROVED	DATE	TEST	DATE	
TESTED	DATE	TEST	DATE	
ISSUED BY	DATE	TEST	DATE	
PROJECT	NO.	TEST	NO.	
E.C.N. L3013				
DATE 11-8-81				
SD510109				